

## PARASOLEIL DATA SHEET

# PSO Series Bracket (offset mount hardware)

Parasoleil's standard hardware integrates engineered connections with an interchangeable design language and known manufacturing tolerances.

### BENEFITS & FEATURES

- Prescribed spacing of fastening points with built-in tolerances for complete system installation
- Single-point mounting hardware maintains consistent panel spacing
- Aluminum and stainless steel components minimize galvanic corrosion

### SPECIFICATIONS

- 5052 aluminum alloy
- Floating nut insert: .250 - 20 threads (.015" min. float distance)
- 400 lb pull out force
- Fasteners: tamper resistant button head or flush mount phillips
- Offset available in 2", 3", or 4" distances

### INSTALLATION RECOMMENDATIONS

- 24" on center max. bracket spacing along panel edges
- Contact Parasoleil for additional guidelines
- Contact local building dept for accurate code requirements

### FINISHES

- Cast Iron, Dark Ash, and Graftone powder coat finishes
- See [parasoleil.com](http://parasoleil.com) for other standard options
- Custom finishes available for an additional charge

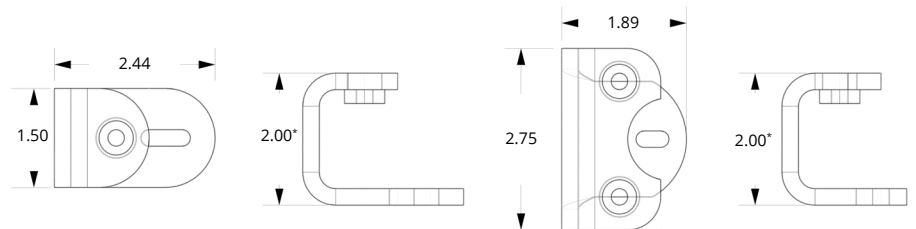

PSO-110

PSO-210

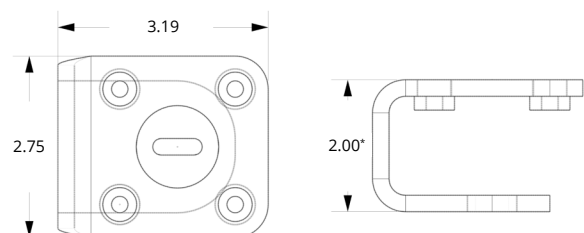

PSO-410

# Parasoleil

303.589.4524  
hello@parasoleil.com  
[parasoleil.com](http://parasoleil.com)

All Parasoleil patterns are protected under copyright © law. Copying, modifying, or any unauthorized use of these patterns is strictly prohibited.